

Production plant for explosives – phase 2

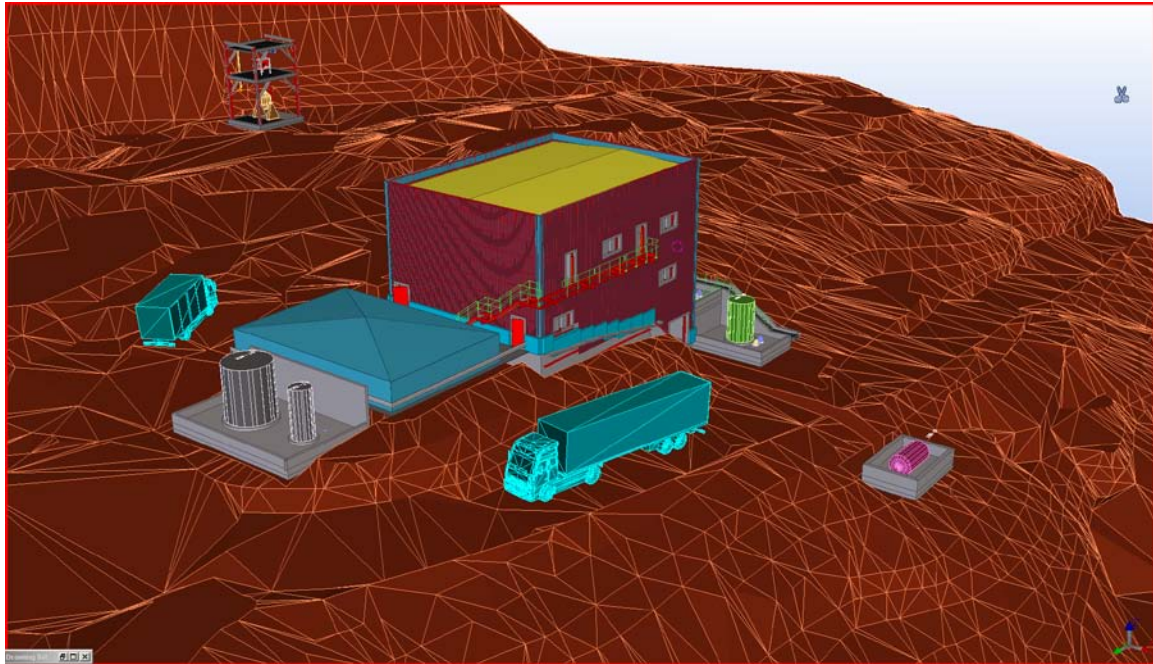

Type of work

Cost and plan study with satisfactory uncertainty for investment decision.

Concept description

A cost and plan study for production plant for 500 ton/y high-energy low sensitivity explosive was completed in the phase 1 study. The phase 2 study is a downscaling to 100 ton/y, with a plan for stepwise increase to 300 ton/y production capacity.

Client

Chemring Nobel AS, Sætre (Former Dyno Nobel AS).

Project cost: 1.3 MNOK

Project duration: Started in January and finished in April 2009.

Nebb Engineering delivery

- Preliminary P&ID's and UFD's
- Heat, material and utility balances
- Major utility systems design
- Equipment specifications
- Plant layout and piping design
- Investment and operation cost
- Concept report

Chemring Nobel's own process specialists and operators were responsible for the safety assessment work